

## Features & Benefits

- Attractive Appearance
- Lower Installation Cost
- Lower Carbon Footprint
- No Power Outages
- Easy to Convert to Solar
- 450Lm-500Lm
- Chameleon CCT™ 3000K & 4000K
- Turtle-Friendly Amber Available
- One Touch Selector Button
- Battery ON/OFF Function Button
- Battery Level LED Display
- Coretemp™ Battery Anti Freeze Technology



Exclusive Free  
Battery Recycling  
Program



10 Year Available  
15 Year Available



## Certifications



Specifications	
Wattage	2.5 Watts LED
Battery	7.4V 10 AH
Solar Panel	Impact Resistant Monocrystalline 8W
Working Temperature	-40 °F - +140 °F
Material	Aluminum
CCT	Standard - 3000K & 4000K/ Others Available
Lifetime	50,000 Hours
Autonomy	2-3 Rainy Days
Height	24"/36"/42" Other Heights Available
Lumens	450Lm-500Lm

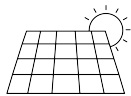

Monocrystalline  
Solar Module

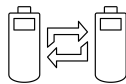

10AH  
Batteries

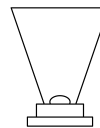

Cree Cob  
LED Chip



IP65



AMERICAN COMBAT VETERAN OWNED COMPANY



405-673-8684

[www.gridshiftsolar.lighting](http://www.gridshiftsolar.lighting)

Corporate: 2803 Broadway Ct. Edmond, OK 73013  
California: 1341 Distribution Way, Suite 20, Vista, CA 92081

Cuesta Sol is a trademark of GridShift Solutions, LLP

**GRIDSHIFT™**  
SOLAR LIGHTING



Wounded Warrior Project

### Lighting Profiles

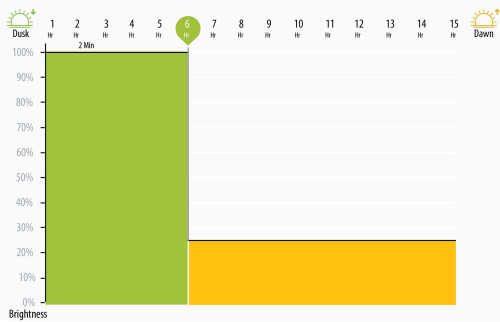

**Profile 1**  
(Turn on/One Flash)  
6H 100% Brightness, then 25% to dawn.

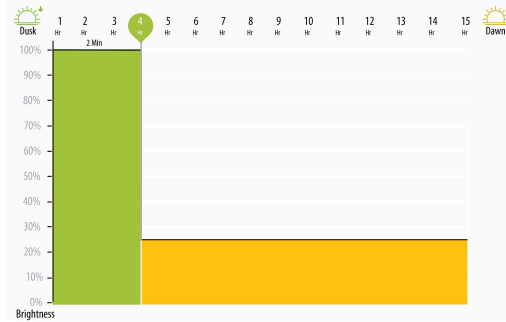

**Profile 2**  
(One Push/Two Flashes)  
4H 100% Brightness, then 25% to dawn.

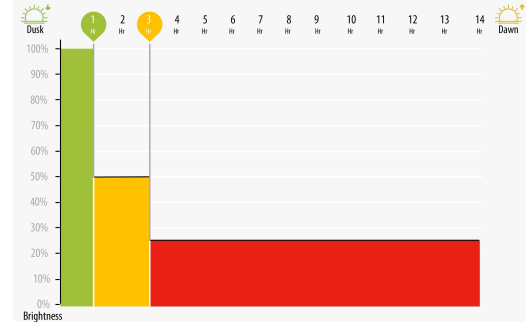

**Profile 3**  
(One Push/Three Flashes)  
1H 100% Brightness, 2H at 50%, then 25% to dawn.

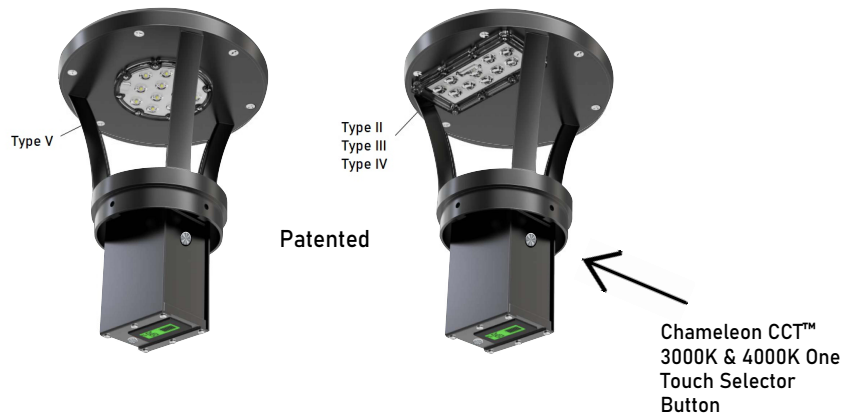

AMERICAN COMBAT VETERAN OWNED COMPANY



405-673-8684

[www.gridshiftsolar.lighting](http://www.gridshiftsolar.lighting)

**GRIDSHIFT™**  
SOLAR LIGHTING

Corporate: 2803 Broadway Ct. Edmond, OK 73013  
California: 1341 Distribution Way, Suite 20, Vista, CA 92081

Cuesta Sol is a trademark of GridShift Solutions, LLP

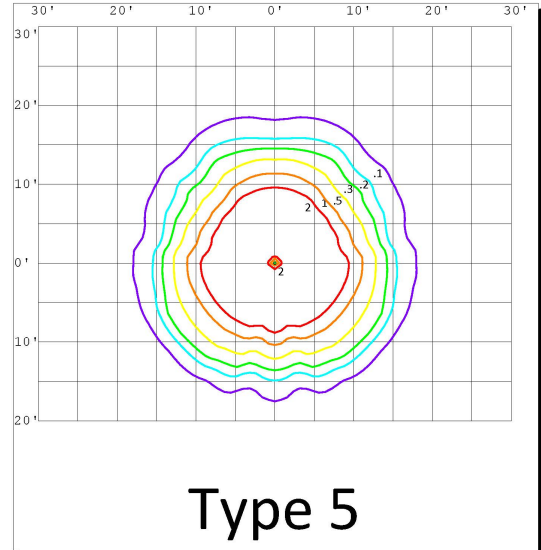
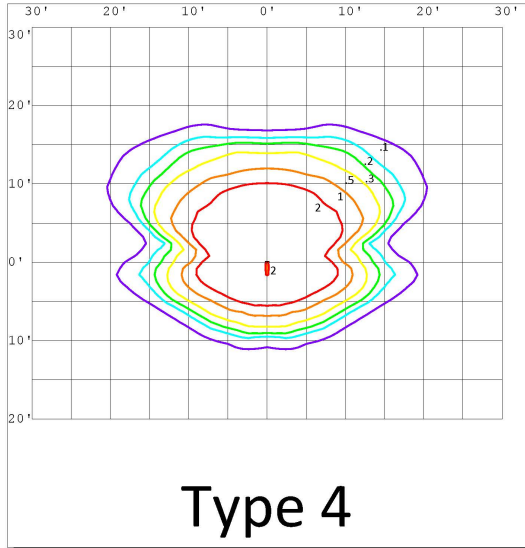

Wounded Warrior Project

**Photometrics**

Model #	Available Optic Types	Fixture Profile Codes	Height
Cuesta Sol CS-BOL-BRI-6R	II / III / IV / V	(See Profile Codes)	24" / 36" / 42" / Custom

Ordering Description Example			
Cuesta Sol CS-BOL-BRI-6R	II	Profile 2	36"

Ordering Description Example			
Cuesta Sol CS-BOL-BRI-6R	II	Profile 2	36"

**AMERICAN COMBAT VETERAN OWNED COMPANY**

 405-673-8684  
[www.gridshiftsolar.lighting](http://www.gridshiftsolar.lighting)

 Corporate: 2803 Broadway Ct. Edmond, OK 73013  
 California: 1341 Distribution Way, Suite 20, Vista, CA 92081

Cuesta Sol is a trademark of GridShift Solutions, LLP

